



M+M, Inc.

M10X™ Sporting Rifle Owners and Operations Manual



M+M, Inc.
Northglenn, CO 80233
866-926-5419
warranty@mm-industries.com
www.MM-Industries.com
Facebook: mplusmindustries

Warning: This firearm could cause accidental death or injury if it is improperly used. Read and understand the information in this manual in its entirety before using the firearm from its packaging, or operating the firearm. If you lend, or transfer this firearm, this manual should accompany the firearm.

Safety Depends on You

MEET THE M10X™: **RATED**



M+M, INC.
NORTHGLENN, CO
WWW.MM-INDUSTRIES.COM
SALES@MM-INDUSTRIES.COM
866-926-5419
PATENTS PENDING
COPYRIGHT © 2015 M+M, INC.



M10X™

EVOLUTIONARY = REVOLUTIONARY™

ACCURACY | RELIABILITY | QUALITY | INTEGRITY™

Safety Depends on You

Notice:

manual is for information purposes only. The owner of the firearm is responsible for safe operation, use, and storage of this and any firearm. Repairs and adjustments to this or any firearm should be taken by a qualified gunsmith or the manufacturer only.

will not be responsible for injury, damage, or death resulting from deliberate or intentional discharge of this firearm, either by the original or subsequent owners of this firearm.

Ammunition

110X™ is a quality, American-made firearm, designed for use with standard, factory-made ammunition manufactured to SAMMI specifications.

Only original, high quality, commercial manufactured ammunition in good condition, and clearly labeled as matching the chamber of this firearm. The chambering of this firearm is clearly marked on the upper receiver and aluminum magazine cover.

Use of reloaded, hand loaded, remanufactured or other non-factory ammunition may result in injury to the user or damage to the firearm. The manufacturer of this firearm will not be responsible for failure, malfunction, or injury resulting from the use of non-factory or defective ammunition.

Firearm should be transported, carried, and stored in an empty, unloaded condition. To prevent accidental death, injury, or property damage, it should only be loaded when you have arrived at a place where you intend to shoot the firearm, and both the shooter and firearm are in the proper position, with the firearm pointed down-range, toward the intended target.

Safety

Always handle this and all firearms as if it is loaded. Always be aware of where the muzzle is pointed. Never point this or any firearm at anything you do not intend to shoot. Never take anyone else's word for it that this or any firearm is unloaded; check the magazine and chamber yourself, with the firearm pointed in a safe direction, and keep your finger off the trigger. Whenever you set the firearm down or hand it to another person, remove the magazine and ensure that the chamber is clear so that the rifle cannot be fired accidentally. Always keep and carry this or any firearm unloaded, with the safety in the "safe" position. Carry this and all firearms in a way that will prevent accidental injury to yourself or others in case of accidental discharge, including circumstances such as accidental

fire or fall, or if you should accidentally drop the firearm. A dropped firearm should be examined by a competent gunsmith before use.

Never leave a loaded firearm unattended. Never leave ammunition out and unattended.

Never leave a firearm cocked, or ready to fire.

Always store this or any firearm in a safe condition, secure from the reach of children, and use safety locking devices. Such devices are readily available at gun stores, or safety kits and locks are available through www.projectchildsafe.org/

Always use factory loaded ammunition in good condition, of the proper caliber and type, designed for this firearm. Inspect ammunition before use. Do not use old or dirty ammunition, as unsafe conditions can arise, and/or damage to the firearm can result.

Understand the proper operation of any firearm before handling it. Never pass a firearm to someone who is not familiar with the operation of that firearm, or who is not familiar with firearm safety.

Always instruct children to respect firearms and firearm safety. If you teach your children to shoot, train them in gun safety, or have them trained by a qualified instructor. Supervise them closely whenever firearms are present. Always teach children never to handle firearms when you are not present. Access children's gun safety programs such as the NRA "Eddie Eagle" program.

When shooting, always know your target, and always be aware of your backstop (area beyond your target,) so that projectiles do not cause accidental death or destruction. A fired bullet can travel in excess of 1.5 miles.

Never place your finger on the trigger until the firearm is pointed at the target and you are ready to shoot.

Before shooting, always inspect the chamber and barrel for obstruction. Loading an obstructed firearm can result in catastrophic failure, injury or death. Never drink alcoholic beverages or use drugs before or while shooting.

Always wear impact resistant eye protection and adequate hearing protection when shooting, or when around shooting.

The noise of discharging firearms can cause permanent hearing loss. There are several possible sources of damage to unprotected eyes present in shooting situations.

Never shoot at a hard surface, such as a rock or cement, or a liquid surface such as water. A bullet may ricochet and travel in any direction, striking you or someone else.

Never discharge a firearm near flammable material.

Health and Environmental Warning:

Operating and cleaning firearms in poorly ventilated areas, or handling ammunition can result in exposure to lead and other potentially harmful substances. Always wash hands thoroughly after using and cleaning your firearm, or handling ammunition.

Misfire Warning:

Failure to fire: If your firearm fails to fire after pulling the trigger, keep the rifle pointed in a safe direction for thirty seconds. After thirty seconds, remove the magazine, and work the charging handle to eject the unfired round. **Keep in mind that if you do not remove the magazine first, working the charging handle to eject the unfired cartridge will also LOAD an additional round into the chamber if there is ammunition in the magazine. ALWAYS remove the magazine before manipulating the charging handle except when you intend to load and fire it.**

Recover and examine the unfired round you have ejected. If the firing pin impression or mark looks normal, in comparison to other fired cases, assume it is a live cartridge and resume shooting with other ammunition. However, if the impression is abnormal, out of place or missing, stop firing and have your firearm inspected by a competent gunsmith. Repeated misfires should be taken as an indication that there is a problem with the firearm or ammunition. In either case, stop firing and have the rifle and ammunition inspected by a gunsmith.

If you fire this firearm and hear an unusual noise, or for any other reason believe the bullet may not have exited the muzzle of the firearm, stop shooting immediately. This is a dangerous condition. Unload the rifle according to the instructions below, and have the rifle checked by a qualified gunsmith.

In any situation regarding misfire, "jamming," failure to fire, or other problems, the first step is to keep the rifle pointed in a safe direction,

REMOVE THE MAGAZINE
then
CLEAR THE CHAMBER.

The rifle is not "SAFE" unless the chamber is CLEAR. You cannot operate the charging handle with a magazine in place and still be sure the chamber is CLEAR. Remove the magazine first, and then ensure the chamber is CLEAR.

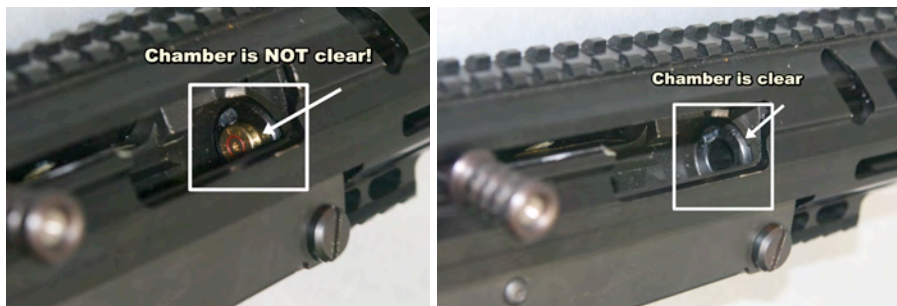

Loading the Magazine

The M10X™ uses standard AK double stack magazines. You should select magazines that are made for the chambering of the rifle you are shooting. The rifle is chambered with the proper chambering on the left hand side of the upper receiver.



Remove the aluminum forearm cover. To load a magazine, use only ammunition of the exact caliber and chambering the rifle is made for. Magazine capacity limits vary from 10 to 30 rounds. If you are not using a standard 30-round magazine, be sure you are familiar with how the magazine you are using should be oriented in the rifle. If you are using a standard, curved, thirty-round "banana" shaped magazine, orient the magazine so that the curved ends are AWAY from your body and the middle of the magazine is towards your body. OR, orient the magazine so the "lug," a small protrusion or tab on one side of the magazine, is towards your body.



With your other hand, orient a cartridge so that the bullet points away from your body. Holding the bullet above the top of the magazine, press it down into the magazine until you hear it "click" into place. Release the cartridge. Repeat until further cartridges cannot be loaded with moderate pressure. Do not over-load a magazine with more cartridges than it is designed for, or past the point that cartridges can be inserted with moderate pressure.

Loading the Magazine into the Rifle

After following all other safety procedures, including checking the chamber and magazine for obstructions, and after you have arrived at the location where you intend to



the magazine must be seated into the magazine well of an unloaded, safe rifle. the rifle is pointed in a safe direction, and the safety lever is set to the safe on (toward the marked "S" on the receiver) you are ready to insert a magazine. accomplish this, orient the magazine so that the "lug" (the small protrusion on the back side of the magazine) is towards the butt of the rifle. Next, rotate the magazine forward from the bottom, so that the top forward lip of the magazine is up with the forward lip of the magazine well, and the bottom of the magazine is flush with the forward lip of the magazine well. Partially insert the magazine into the well in this position. Now, rotate the magazine backwards while pushing the magazine into the magazine well with slight pressure. The top of the magazine will rotate into the magazine well. When the magazine release "sets" (engages) below the lug on the magazine, the magazine is inserted properly.



To remove the magazine, grip the magazine with one hand, while laying a finger on the magazine release lever. Pinch the magazine release lever towards the magazine, and rotate the bottom of the magazine towards the muzzle of the rifle. The magazine will come out of the magazine well, and can be removed.



Safety Depends on You

Firing the Rifle

Once the magazine is in place, and the rifle is oriented in a safe direction (the direction you intend to fire,) you must chamber a round. To do so, begin by switching the safety lever to the fire position (toward the marked "F" on the receiver.)



This will allow the bolt to be manipulated. Now, pull back on the charging handle until it stops. At this time, the charging handle should be pulled all the way back of the slot of the receiver in which it rides.



From that position, RELEASE the charging handle so that the internal spring in the firearm can carry it forward. *Do not ease the charging handle forward. Do not hold the charging handle while it moves forward under the power of the internal spring.* Allowing the spring to carry the mechanism forward will insure that the cartridge is fully seated in the chamber, and the bolt is locked. A partial



Safety Depends on You

letion of this maneuver can leave the rifle “out of battery” due to an improperly bered round, and the firearm will not fire.

At this time, the rifle is ready to fire. Point it towards your target, take aim, and ze the trigger until the rifle discharges.

This is a semi-automatic firearm. After firing, a shell will be ejected, and the anism will re-load the rifle each time you discharge the rifle, until the nition is expended. At any time you want to stop shooting, switch the safety anism to safe (“S”) but continue to keep the rifle pointed in a safe direction. Do ill the trigger with the rifle on safe. Do not rely on the safety to prevent the rifle firing.

Adjusting the Rifle Sights

Your M10X™ comes from the factory with sights installed on the picatinney hese “peep sights” are adjustable for elevation (point of impact up or down) indage (point of impact left or right.) In addition, these sights fold down when use to facilitate mounting optical, laser, or other sight systems on the rail, and re “back up” sights, should some other installed system fail in the field.

Peep” style sights are used by looking through the small aperture or hole in the ight, and centering the top of the forward site post in the “visual window” ed by looking through the aperture. This system tends to be more precise for shooters than other sight systems, and is based on the proposition that ring images is a natural function of the human eye. In use, the shooter should r the top of the forward sight post in the field of view, and place the top of that ither ON or JUST UNDER the point on the target that the shooter intends to epending on preference and on how the sights have been adjusted. tionally, the sights are often adjusted to shoot “on” for hunting, in order to

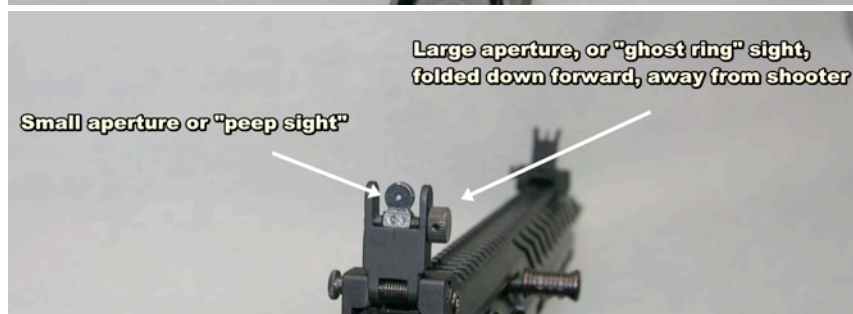

ate faster shots, and “just under” for target shooting, so that the front post doe obscure the target during target shooting.

The factory sights have two “peep” apertures, and you can choose one or the according to your preference simply by pushing whichever aperture is ntly “up” forward or back, in the direction that is “away” from the other sight re, which is currently in the “down” position. Generally speaking, the large re is used for faster target acquisition, and in low light, while the smaller lend to more precise shooting and further targets, in good light conditions.

Various kinds of ammunition, and various lots of ammunition, will hav what different trajectory characteristics. For that reason, it is usually necessar e shooter to “sight in” a new rifle with the factory sights, as well as with any on” sights the owner of the rifle has installed.

To adjust the factory sights, follow these steps:

Both sights (front and rear) should be locked into their up-right position. They ring-loaded, and will pop up on their own when released by pressing the a located on the left side of the rifle when the logo on the sights are pointing

Once the sights are locked up-right, fire three carefully aimed shots at a targe n the range of your ability to hit the target with all shots. The center point o three shots is the point which you will adjust towards the bull’s eye, or the r of the target.

The front sight, which consists of a post situated between two protective ears o , can be adjusted for elevation. There is a retaining pin inside the left ear of the sight, and this pin prevents the post from being inadvertently turned to : r or lower position. First, using a slender object such as a very small driver or a toothpick, depress the retaining pin by pushing straight down on it. Now the front sight post can be rotated, turning it so that threads will raise o the post.

If you are hitting above the point at which you are aiming, raise the post by ig it counter-clockwise. Use small adjustments until you are familiar with hov elevation you are getting with each turn.

If you are hitting below the intended point of impact, turn the post clockwise ing the front sight post. Again, use small adjustments.

After adjusting the front sight for elevation, shoot again, and find the center o second group of three shots. Adjust further as needed.

The rear sight can be adjusted for windage. If you are hitting to the left of th you intend to shoot at, move the rear sight right by turning the knob that i d on the rear sight. To move the aperture right, rotate the knob clockwise. I re hitting to the right, move the sight left by rotating the knob counter wise. The knob is “click adjustable,” meaning it clicks with each incrementa ment, which allows you to make changes and then return the sight to its us position if you count the number of clicks as you move it.

Adjusting the sights is not an “intuitive” process for most new shooters, or for those unused to a particular style of sight system. If you have trouble adjusting sights, visit your gun dealer. The dealer will be happy to show you how to adjust sights, and can help advise you on sighting your rifle. The sights provided with M10X™ are precision sights, and should perform well when you are familiar with their operation.

Sight Alignment – Aperture Sights

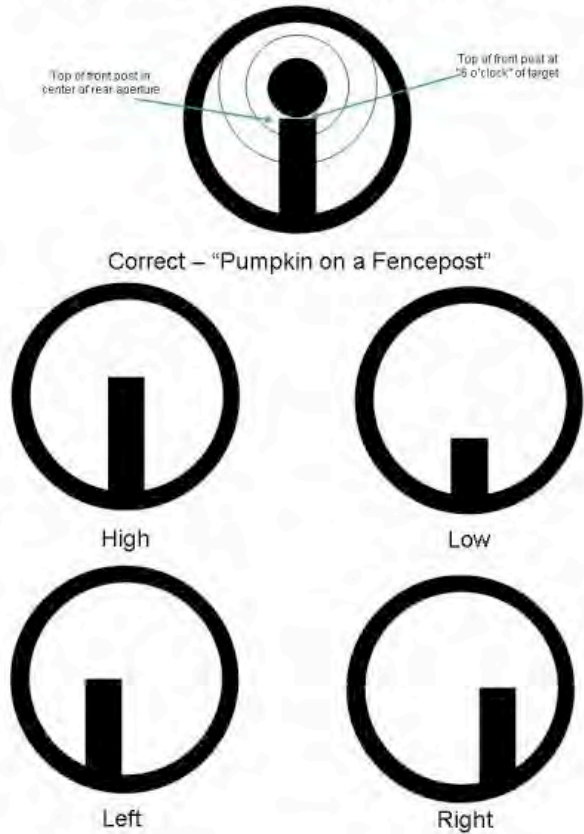

Unloading the Rifle

When you have finished shooting, unload the rifle and insure that all ammunition has been expended. Begin by following the steps below to unload the rifle. Once the magazine is removed, with the rifle pointed in a safe direction, pull the charging handle backwards, and hold the action open while you look inside the chamber. Ensure that the chamber is empty (no cartridge head is visible). Then, release the charging handle, and switch the safety to safe (“S”). Your rifle can now be placed in storage or a transportation case. For further safety, you can insert a plastic or wood object partially through the ejection port to prevent the bolt from fully closing. Do not use a steel or metal object for this, though you can use an (empty) brass cartridge case.

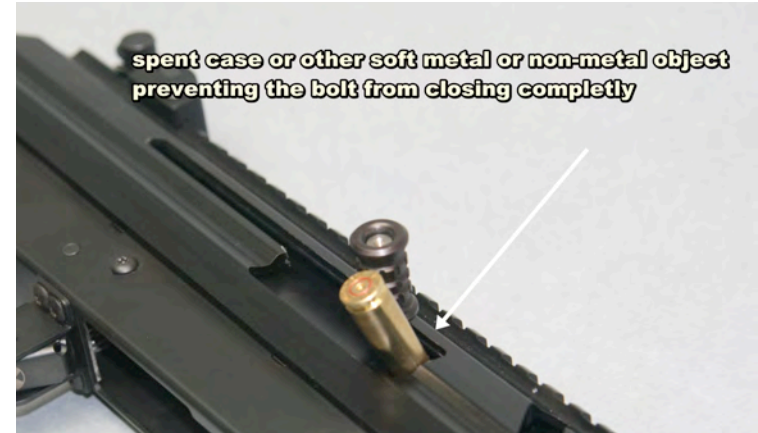

Disassembly

Disassembly for cleaning or inspection is periodically necessary, and can be accomplished in a few steps. To disassemble the rifle, begin with a safe, unloaded rifle with the magazine removed.

Depress the receiver latch located just forward of the buttstock, on the left side of the rifle. This will allow the upper and lower receivers to separate, and the rifle will “open,” on a hinge pin.

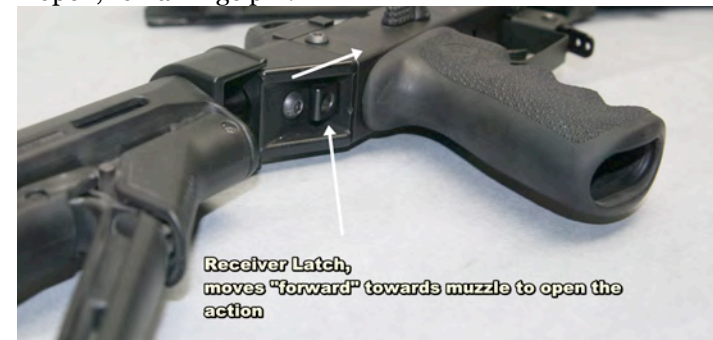

Place the open rifle on its side on a clean surface such that the charging handle

In the center of the outer end of the charging handle you can see a metal surface with a dimple in the center. Using a slender object such as a cartridge, or a nail, press the metal surface by pressing the slender object against it. When you feel the surface give way until it stops, hold the metal surface down while you pull the charging handle straight up out of the rifle.



You can now reach into the lower side of the upper receiver and push the bolt carrier backwards, toward the rear of the upper receiver. It will move backwards until it is removed from the receiver, out the back of the rifle. Carefully set these parts aside, along with the charging handle.

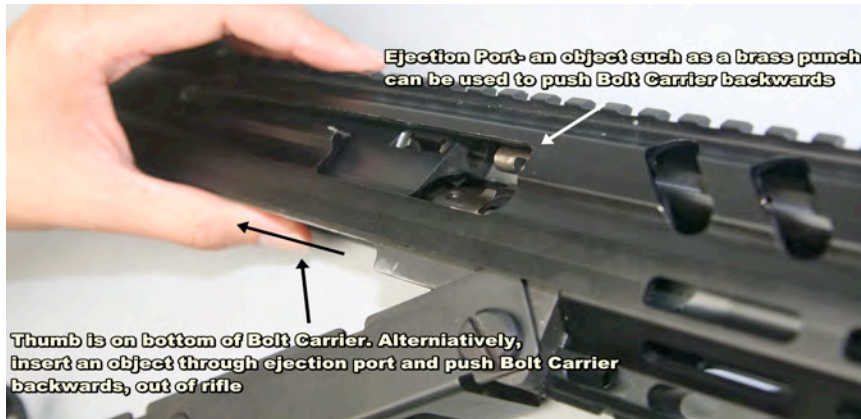

You now have access to clean the internal parts of both the upper and lower receivers, as well as the bore of the rifle. Always clean the bore of the rifle by inserting cleaning rods and attachments from the chamber side of the rifle (NOT the muzzle end of the barrel!) according to the instructions received with your cleaning kit.

Further disassembly is not necessary for routine maintenance, but can be accomplished by disassembling the gas valve, piston and cylinder assembly.

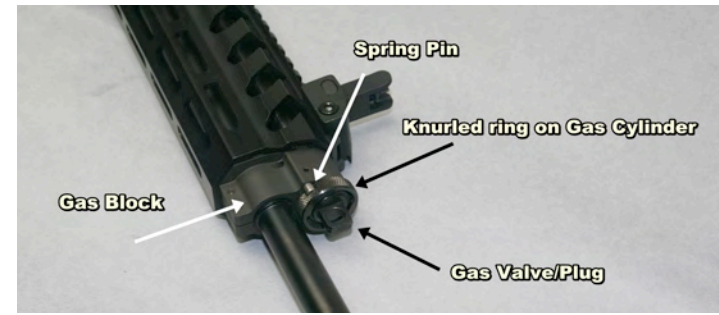

Begin disassembling the gas valve by locating the spring-loaded pin on the side of the gas cylinder, just forward of the gas block. Depress that pin and hold it down. Rotate the knurled (textured) ring which is at the end of the gas cylinder while you rotate the gas valve plug counter-clockwise as seen from viewing the assembly from the muzzle end of the rifle (do NOT point the rifle at your face or head!).

After rotating the gas valve a quarter turn or more, you can pull it straight out from the muzzle-end of the barrel. Set the gas valve aside.

Remove the gas cylinder next. To remove it, depress the spring pin again and rotate the gas cylinder by grasping the knurled ring at the forward (muzzle) end of the rifle.



After rotating the gas cylinder and turning it in either direction. If the action has already been disassembled, and the charging handle is removed, the gas piston will come out with the gas cylinder. If the charging handle has not been removed, then the piston will remain in place and the cylinder will be extracted from over the piston. In either case, the cylinder is removed by continuing to turn and rotate the assembly until the gas piston is free.



The piston and the return spring around the piston may remain engaged. If the piston remained behind after removing the cylinder, it can be removed now by turning the charging handle and rotating the piston in place until it is free (one turn.) Note the position of the channel cutout in the piston before rotating it. This will help you to properly orient the piston when you replace it.

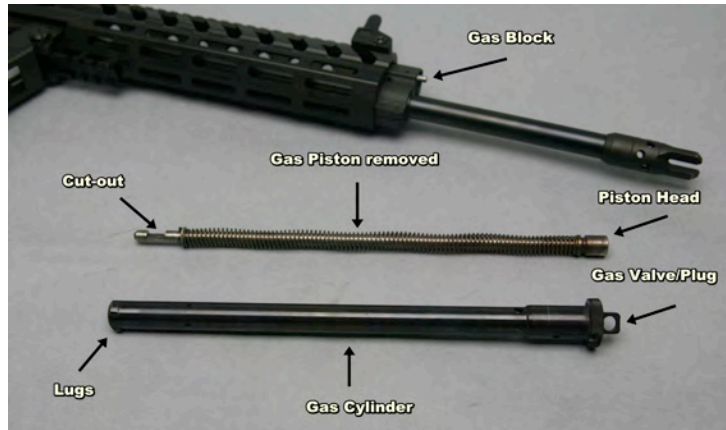

The final step in disassembly involves removing the hinge pin that holds the upper and lower receiver together. This pin is a screw-pin, and can be removed by turning one side of the pin in place while the other side is turned with a small coin screwdriver. If you do not have the proper (Gunsmithing) screwdrivers, using a dime or a coin will prevent marring the metal.

After unscrewing the pin, it may fall free, or you may need to drive it out with a punch. Do not drive the screw-pin out with a steel object, as it is threaded internally, and marring the threads will cause problems in reassembly. Use only an object made of softer metal, plastic, or other material that will not damage steel parts.

After removing the screw-pin, the upper and lower receivers can be separated, and the barrel and upper receiver can be removed from the extruded chassis. It is necessary to remove the hinge pin to clean the rifle, but it can be removed if desired for convenience.

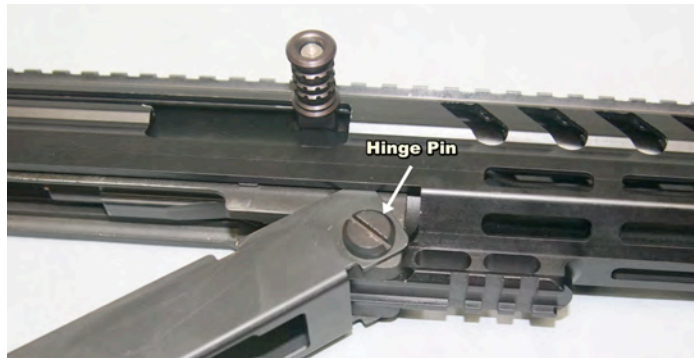

FURTHER DISASSEMBLY IS RECOMMENDED, except by a qualified gunsmith.

Assembly

The rifle can be reassembled by reversing the disassembly steps.

We advise you to read the entire assembly instructions once before beginning to assemble the rifle.

The gas cylinder is installed by inserting it through the gas block. Insert it so the lugs on the posterior end go through and seat toward the back (rear) of the receiver. The anterior (forward) end consists of the knurled ring and spring-loaded notch which extends from the front of the gas block. Start by holding the cylinder such that the notch for the spring pin is closest to the barrel. We will call this position "6:00" and the side furthest from the barrel "12:00". Insert the cylinder in the 6:00 position.

When the cylinder is in place, and seated as far through the gas block as possible, turn the cylinder clockwise until you feel the lugs engage, the spring-loaded pin release and lock the knurled ring into place. With the cylinder properly locked, now install the piston by inserting it through the cylinder. One end of the piston has a cut-out for the charging handle to engage, while the other end is the piston head. Insert the cut-out end first, guiding it through the cylinder until it is seated through the ejection port in the receiver. Rotate the piston until the cut-out is down (towards the magazine well) and is square to the orientation of the barrel.

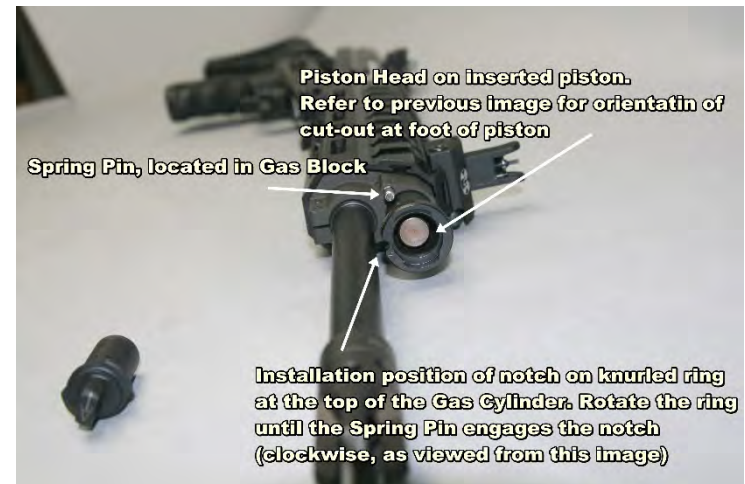

Finally, install the gas valve. It must be installed so that the arrow on the handle of the gas valve is oriented towards the barrel of the rifle. The gas valve has broad lugs which fit down into openings in the top of the gas cylinder. Insert the valve and rotate it to the proper orientation. Note: you cannot join the bolt carrier to the gas cylinder unless the gas valve is inserted. Orient the bolt carrier so that the cutout of the charging handle is forward (towards the muzzle). Inserting the bolt and bolt carrier is best accomplished by extending the bolt as far forward in the carrier as it will go (if it comes out of the bolt carrier, re-insert it, rotate it clockwise as far as possible (as seen from the bolt face) as you push it as far forward in the carrier as possible by pushing on the end at the rear of the bolt carrier.)

Once the bolt carrier is inserted, use a slender object to push the carrier forward until the bolt rotates and is seated all the way back into the carrier.



With the cylinder/piston assembly in place before you insert the bolt carrier, the bolt carrier seated as far forward as possible, you can now re-insert the charging handle.

You will see a small “hook” at the “inward” end of the charging handle. Position the charging handle above the slot in the bolt carrier made to receive it. The “hook” should be forward. Depress the metal surface in the “outer” end of the charging handle completely with a slender object such as a small screwdriver or the pointed end of a cartridge. When you feel that surface “bottom out,” you have relieved the pressure on the “hook” at the other end of the charging handle. Insert the charging

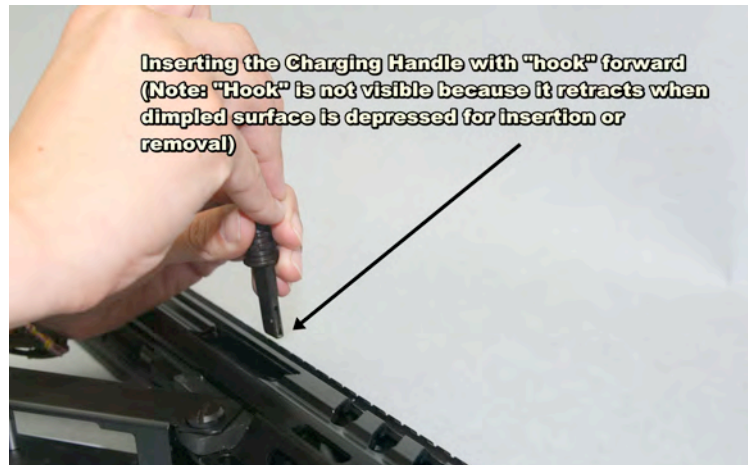

handle firmly while continuing to press down with the slender object. The charging handle is seated when there is less than ¼ inch of clearance between the knurled end of the handle and the surface of the extruded chassis.

At this point, all parts should be properly installed, and you should now adjust the gas valve. Depress the spring pin, rotate the gas valve slightly, and then release the spring pin. Now continue to rotate the gas valve until you hear it “click” into place. The arrow at about the 6:00 position. The “click” is the spring-loaded pin in the lock moving to lock the gas valve into place. For further adjustments, press down on the gas valve and turn. Please consult the “Gas Valve Plug Adjustment” section for more information about adjusting the Gas Valve. However, for cleaning the rifle, note that the Gas Valve is marked with an arrow, and the face of the knurled section of the gas cylinder is marked with the numbers, “1,” “0” and “2.” When the cylinder is properly installed, the “1” should be located in about the

Safety Depends on You

position (closest to the barrel of the firearm, pointing directly at the barrel) to align the Gas Valve such that the arrow is pointing to the “1” position. This is the normal firing position.

Gas Valve Plug Adjustment

The M10X™ rifle comes standard with an adjustable gas valve. The adjustment is designated as “1,” “0” and “2.” The normal operating position is for the arrow on the Gas Valve Plug to be oriented to the “1” position, as indicated on the cylinder above the knurled end at the muzzle end of the gas cylinder.

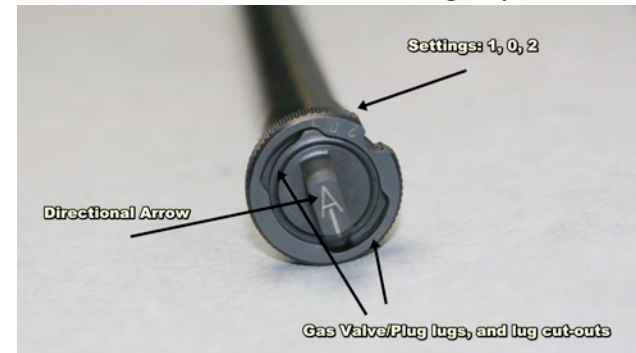

The “0” position blocks the gas apertures, so that gas is not vented into the mechanism of the rifle. In this condition, the rifle operates as a “repeating rifle,” and not as a semi-automatic rifle, and the charging handle must be operated with each shot in order to load the next round. This setting may be used for instructing new shooters, to increase safety, or for operating the rifle with a silencer, if you have obtained a silencer and mounted it.

The “2” position allows for a greater than normal amount of gas to be vented into the rifle’s operating mechanism. There are limited circumstances under which this might be desirable. Once such circumstance can occur while operating the rifle in extremely cold conditions (below zero degrees.) Extremely cold temperatures can affect the burning rates of the propellant found in ammunition, causing the gas pressures to drop, and it is possible for the pressure to drop enough to cause the rifle to function less reliably. Likewise, if the rifle has become very dirty and is not cycling properly, or if unusually low-pressure ammunition is being used. In such cases, it may be helpful to adjust the valve to the “2” position, which will allow more gasses to enter the gas system. However, operating the rifle in the “2” position when there is NOT a low pressure situation puts greater stress on the operating parts, and it is not recommended to operate the rifle on the “2” position unless necessary.

Cleaning

We recommend using high quality, commercial solvents for cleaning your rifle. Your local dealer will be happy to recommend any of many products. Be aware that some of these products cannot be safely mixed. Discuss these issues with your local dealer as you select your cleaning products, as well as proper cleaning methods and procedures.

Safety Depends on You

Both the rifle bore and the internal parts should be cleaned periodically, usually after shooting the rifle. With proper care, your M10X rifle will provide you many years of use. Be aware that some imported ammunition may be corrosive, use of corrosive ammunition requires more thorough and careful cleaning. We do not recommend the use of corrosive ammunition, but if you use it, you should be sure to clean every accessible surface of the rifle as soon as possible after every use. Some customers have reported that imported ammunition that is marked as non-corrosive actually is corrosive, so if you use imported ammunition, we recommend rough cleaning after every shooting, regardless of the markings on the ammunition.

Lubrication

Your M10X™ rifle has been designed to run safely and effectively with a variety of lubrication conditions, and the design is tested to be operational with no lubrication or with a surplus of lubrication. However, the life of the rifle will be extended with proper lubrication, and we recommend maintaining proper lubrication at all times.

M+M, Inc. has high quality lubricants available, designed and tested to aid in protecting the rifle in extreme conditions, and we recommend using M+M lubricants. However, any appropriate firearm lubricant from any quality firearms or firearm accessories manufacturer can be used.

All internal parts that are removed for cleaning should be lubricated before reassembling the firearm. Again, the rifle will function with a wide variety of lubrication levels, but the ideal condition is a light film of lubrication on all parts that have bearing surfaces (surfaces in contact with other surfaces, particularly surfaces of moving parts).

As you use your rifle, you will begin to note certain places where slight wear is apparent. This is normal, and is not cause for concern. The significant parts of your rifle have been treated with a nitride finish which is very hard, and a slight rounding of bearing surfaces over time is normal. However, all of these places where wear becomes visible are particularly appropriate for lubrication. They include: The bolt and bolt carrier assembly, though the bolt face should be wiped clean before assembly. The gas piston, and the return spring which surrounds the gas piston. Lightly lubricate the trigger/hammer assembly, and the hinge pin, as well as the safety lever.

No parts should be lubricated to the point that lube is running, dripping or overflowing in the firearm. It is possible for lubricants to render the primer of a cartridge inoperative, so that the cartridge will not fire. Do not allow lubrication to run on the magazine or come into contact with ammunition that is or is not loaded in the magazine.

Accessories

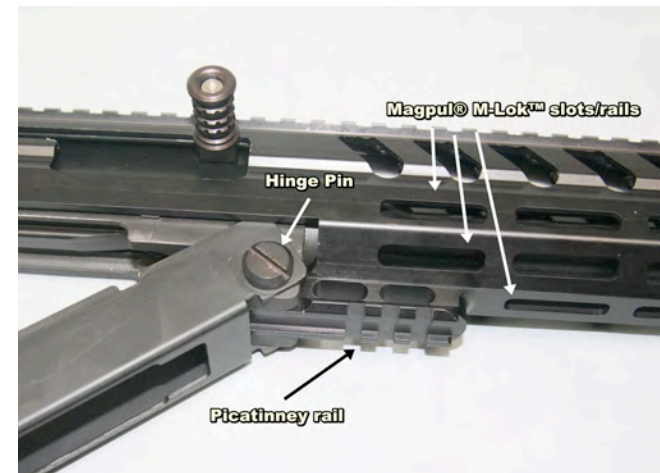

The M10X™ rifle is adaptable for add-on accessories in the following manner:

- 1. The aluminum forearm cover includes a picatinny rail on top, and a total of twenty-four (24) slots, on the sides and bottom, compatible with the Magpul® M-LoK System.
- 2. The Phoenix Technology® stock adapter is compatible with all AR-15 commercial spec stocks and will accept any stock designed for that adapter.
- 3. There is a short picatinny rail on the under-side of the aluminum forearm, just forward of the Hinge Pin. These rails will allow you to choose from a wide variety of optics, lights, sights and bipod mounts, and lasers. M+M makes no recommendations and does not guarantee that all of these will be appropriate and useful on your rifle. Accessories are chosen on a personal preference; what works for one shooter, may not work for another. We encourage you to discuss these options with your dealer or try them on your rifle before purchasing them. However, these options do make your M10X™ among the most versatile in the marketplace.

Domestic Limited Warranty

Thank you for purchasing the M+M, Inc. M10™ Series Sporting Rifle. Our intention is for you to enjoy this quality firearm for years to come. To that end, our Customer Service staff is well-trained and available to help you with any issues that arise in using your new rifle. Customer Service is available by phone, fax, mail or email. Contact Customer Service for warranty repairs or questions regarding the operation of your M10™ Series Sporting Rifle.

M+M, Inc.
 Customer Service
 Northglenn, CO 80233
 P: 866-926-5419
 F: 888-236-2619
warranty@mm-industries.com

Important: Read this entire document BEFORE returning firearms for service.

Warranty Registration

In order to take advantage of the M+M, Inc. Limited Warranty, **you MUST register your firearm within 90 days of the original purchase of the new firearm.** You can register using the Warranty Registration Card inserted in the original materials that are shipped with your new firearm, or by going on-line to: m+m-industries.com/warranty

All requested information must be provided in every field of the Warranty Registration Card or web page in order to activate your warranty.

M+M, Inc. M10™ Series Sporting Rifle Limited Warranty

Limited Warranty: Your M+M, Inc. M10™ Series Sporting Rifle will be serviced for defects in material or workmanship, at no charge to the original purchaser of a M10™ Series Sporting Rifle. Defective parts will be replaced or repaired at the discretion of M+M, Inc. for the duration of this limited warranty.

Term of Warranty: The Warranty Period for the M10™ Series Sporting Rifle is 1 year from date of original retail purchase. *Be sure to retain your sales receipt as proof of purchase date. Claims will not be honored without sales receipts.*

Exceptions: If a firearm submitted for repair is found to be within operating specifications, a service fee of \$95 will be assessed before your firearm is returned to the customer.

The rifle must be returned fully assembled and must be accompanied by the original magazine before we can perform any warranty service work. Please do not add any aftermarket items to M+M, Inc. with the firearm. M+M, Inc. will not be responsible for lost, missing or damaged aftermarket accessories.

IMPORTANT: IF END USER MAKES ANY MECHANICAL MODIFICATIONS, ALTERATIONS OR USES UNAUTHORIZED PARTS, M+M, INC. WILL NOT BE RESPONSIBLE FOR ANY WARRANTY CLAIMS AND/OR ASSUME RESPONSIBILITY FOR THE NON-FUNCTIONING OF THIS FIREARM. YOUR M10™ SERIES RIFLE HAS BEEN DESIGNED AND MANUFACTURED TO PERFORM PROPERLY WITH THE ORIGINAL PARTS AS INSTALLED AT THE FACTORY. IT IS THE OBLIGATION OF THE CUSTOMER TO INSURE THAT ANY PARTS REPLACED OUTSIDE THE FACTORY ARE THE PROPER PARTS, PROPERLY INSTALLED, AND HAVE NOT BEEN MODIFIED OR ALTERED IN ANY WAY. MODIFIED, ALTERED OR INCORRECTLY INSTALLED PARTS CAN RESULT IN DAMAGE TO THE FIREARM, INJURY OR DEATH TO THE OPERATOR OR BYSTANDERS DUE TO SUFFICIENT MALFUNCTION. ALWAYS HAVE YOUR RIFLE SERVICED BY A QUALIFIED GUNSMITH, CHECK ANY WORK THAT MAY HAVE BEEN DONE BY ANYONE OTHER THAN A QUALIFIED GUNSMITH

How to Obtain Warranty Service:

Notify Customer Service that you have an issue. Some issues can be resolved without sending the firearm in for service. Service is fastest when you notify Customer Service of the issue by phone.

Describe your problem to Customer Service. They will need to know what is happening with the rifle and how you discovered the problem. If you have a broken part that you can identify, please consult the diagram and list of parts included in your Owner's Manual so that you can try to identify the exact part that is broken by name. If you don't know what part is broken or exactly what the problem is, describe what is happening that makes you believe there is a problem.

Provide the model number, serial number and date of purchase of your firearm. It is best to have these things ready when you call, or include them in the written contact.

If deemed necessary, your Customer Service Representative will give you instructions for returning the rifle to the factory. You must follow the instructions. Your Customer Service Representative gives you regarding the return of the firearm either you ship it or you give it to your dealer to ship.

Various Local, State and Federal laws govern the transfer and transportation of firearms. For that reason, we recommend that you consult a dealer in your state for information on how to transport your firearm. M+M, Inc. is not responsible for enforcing the applicable laws of every state and local ordinance. That is your responsibility.

LIMITATIONS: THIS WARRANTY INFORMATION IS PROVIDED TO THE ORIGINAL OWNER OF THE M10™ SERIES SPORTING RIFLE, AND NO PERSON IS AUTHORIZED TO EXTEND OR MODIFY OR ACCEPT ANY OTHER WARRANTY ON BEHALF OF M+M, INC. BEYOND THIS WARRANTY, EITHER AT THE DEALERSHIP WHERE YOU PURCHASED THE FIREARM OR AT THE FACTORY. M+M, INC. ASSUMES RESPONSIBILITY FOR DEFECTS IN MATERIALS AND WORKMANSHIP AS SET OUT IN THIS WARRANTY INFORMATION, AND M+M, INC. ACCEPTS NO FURTHER RESPONSIBILITY OF LIABILITY BEYOND WHAT IS SET OUT IN THIS DOCUMENT. IN NO CASE OF THIS WARRANTY NEITHER M+M, INC. NOR ITS REPRESENTATIVES WILL BE LIABLE FOR DAMAGES BEYOND THE LIMITS OF THIS WARRANTY. NO WARRANTIES EITHER EXPRESSED OR IMPLIED EXTEND BEYOND THE ORIGINAL WARRANTY PERIOD FROM THE DATE OF PURCHASE OF THE FIREARM.

Thank you for purchasing the M+M, Inc. M10™ Series Sporting Rifle. Our intention is for you to enjoy this quality firearm for years to come. To that end, our Customer Service is well-trained and available to help you with any issues that arise in using your new rifle. Customer Service is available by phone, fax, mail or email. Contact Customer Service for warranty repairs or questions regarding operation of your M10™ Series Sporting Rifle.

M+M, Inc.
 Customer Service
 Northglenn, CO 80233
 P: 866-926-5419
 F: 888-236-2619
warranty@mm-industries.com

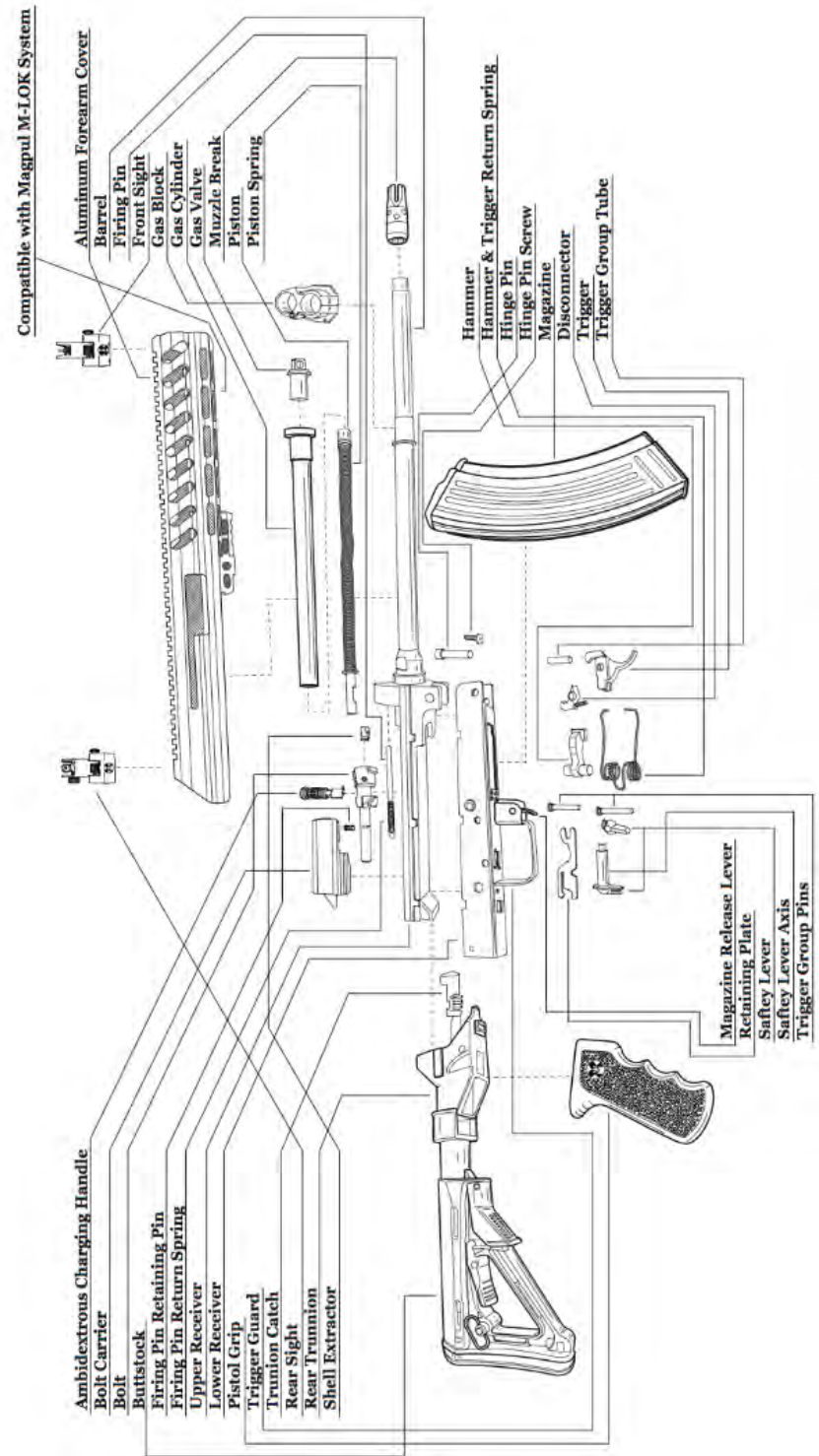



TM

M+M, Inc.
Northglenn, CO 80233
P: 866-926-5419
warranty@mm-industries.com
www.MM-Industries.com
Facebook: mplusindustries

"EVOLUTION OF THE MIO™"



THE MIO™: PROGRESS IS NATURAL™

M+M, INC.



NORTHGLENN, CO
WWW.MM-INDUSTRIES.COM
SALES@MM-INDUSTRIES.COM
866-926-5419
PATENT'S PENDING
COPYRIGHT © 2015 M+M, INC.

Safety Depends on You

Safety Depends on You